



MAYNARD
ESTATES



Plot 47 Grange Meadows, Coalville, LE67 2NB

£420,000

** Move In Autumn 2026 **

Phase 2 Launch Weekend 23rd & 24th May 10am - 4pm - Developer Incentives

"The Canterbury" is a substantial FOUR DOUBLE BEDROOM detached home with a large master bedroom benefitting from a stylish en-suite along with separate dressing room area.

The ground floor boasts a spacious living room along with a wonderful open plan living, kitchen diner with fully integrated appliances and bi-fold door which overlook and open onto the homes lovely sun-lit south facing rear garden plot. A separate utility room along with a convenient ground floor WC add to the home practical design.

In addition to the home benefiting from large bedrooms on the first floor, a beautiful and stylish four piece family bathroom completes the homes wonderful and substantial internal accommodation

The double width, block paved driveway is another practical feature, providing side by side off road parking and leads to the homes sizeable integral garage.

ON THE GROUND FLOOR

Entrance Hall

Downstairs WC 2'10" x 5'10" (0.87 x 1.78)

Living Room 11'2" x 20'4" (3.41 x 6.21)



Open Plan Kitchen Living Diner 29'5" x 14'5" (8.97 x 4.41)



Utility Room 8'8" x 5'1" (2.65 x 1.55)



ON THE FIRST FLOOR

Landing

Master Bedroom 11'10" x 15'1" (3.61 x 4.62)



En Suite 8'3" x 3'8" (2.53 x 1.14)



Dressing Room 6'8" x 6'2" (2.05 x 1.90)

Bedroom Two 10'1'4" x 15'4" (30.9 x 4.68)



Bedroom Three 10'8" x 11'3" (3.26 x 3.45)



Bedroom Four 9'11" x 10'7" (3.04 x 3.23)



Family Bathroom 8'0" x 6'8" (2.44 x 2.05)



ON THE OUTSIDE

Rear Garden



Front Garden

Driveway

Integral Garage 9'8" x 19'11" (2.95 x 6.08)

Floor Plan

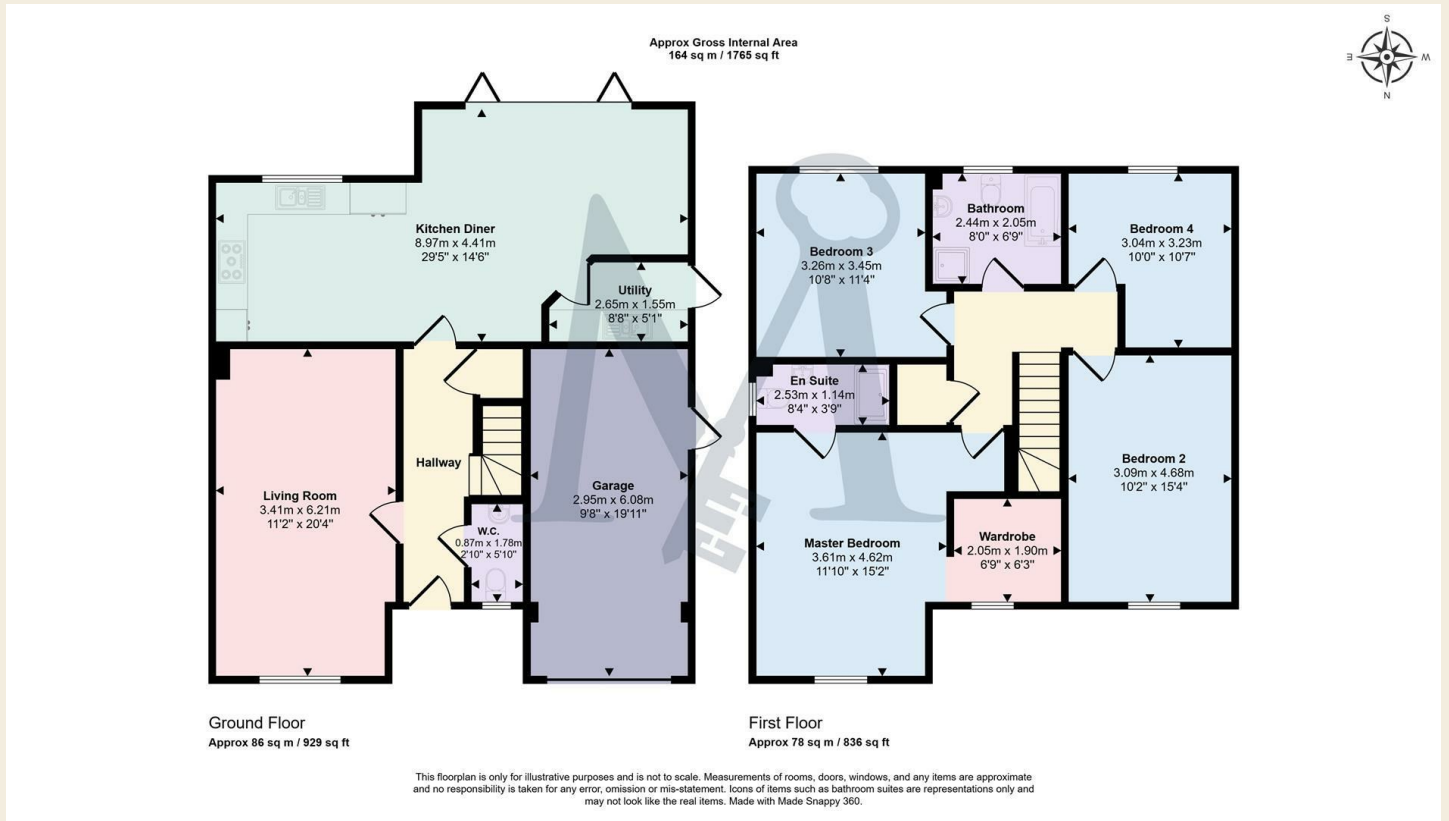

Area Map

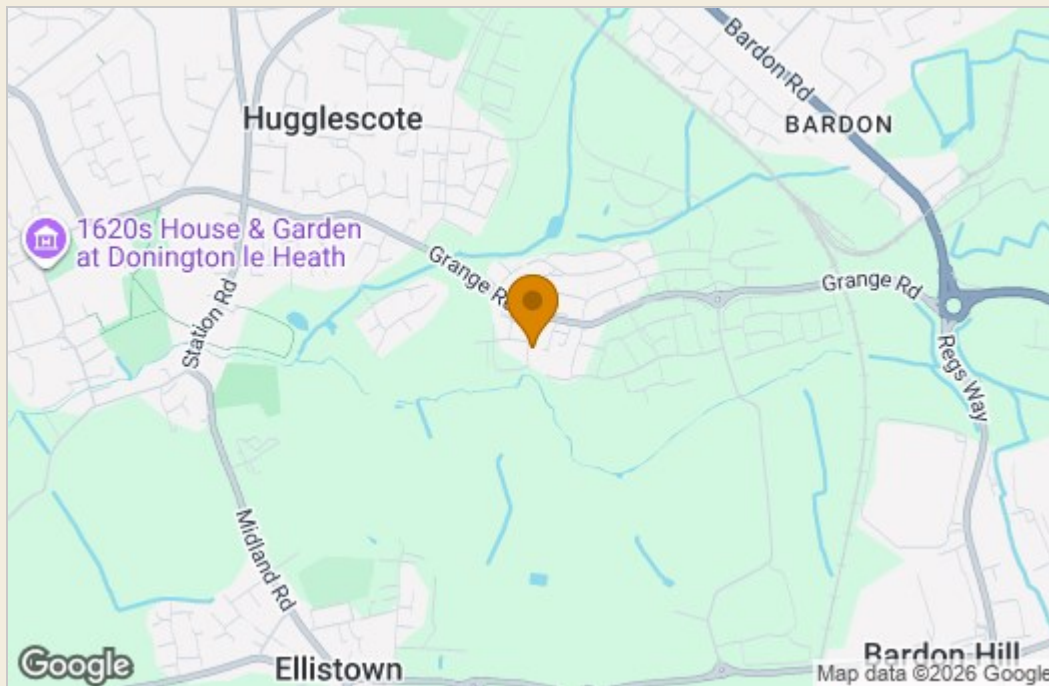

Energy Efficiency Graph

Energy Efficiency Rating		Current	Potential
Very energy efficient - lower running costs			
(92 plus) A			
(81-91) B			
(69-80) C			
(55-68) D			
(39-54) E			
(21-38) F			
(1-20) G			
Not energy efficient - higher running costs			
England & Wales		EU Directive 2002/91/EC	

These particulars, whilst believed to be accurate are set out as a general outline only for guidance and do not constitute any part of an offer or contract. Intending purchasers should not rely on them as statements of representation of fact, but must satisfy themselves by inspection or otherwise as to their accuracy. No person in this firm's employment has the authority to make or give any representation or warranty in respect of the property.